



SERIE **049** ■

PNEUMATIC COUPLINGS
PNEUMATISCHE KUPPLUNGEN



Interchangeability - Kompatibilität
Tuthil-Hansen 180 & 280 Serie

Temperature Range -Temperaturbereich
-20°C +100°C (-4°F +250°F)

Working Pressure - Betriebsdruck
0 - 48 bar (0 - 700 PSI)

Flow capacity - Nennweite
NW - 3.2=1/8" (8mm²)

Material - Material

- Coupler Body - Kupplungsgrundkörper : Brass - Messing
- Back Part - Hinterteil : Brass - Messing
- Sleeve - Hülse : Brass - Messing
- Valve - Ventil : Brass Tire Valve
Messing Reifventil
- Springs - Federn : Stainless Steel -
Edelstahl
- Balls - Kugeln : Stainless Steel -
Edelstahl AISI-316
- Seals - Dichtungen : Nitrile (Ni) - NBR (Ni)
- Plug - Nippel : Brass - Messing

Couplers and Plugs
Kupplungen und Nippel

Connection
Anschlüsse
Ø

Order No
Bestellnr.

SW

L

ØD

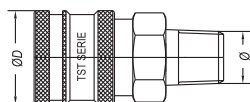

Male Thread Coupling
Kupplung mit Aussengewinde

NPT 1/8"	049 TG 10	14	35	16
NPT 1/4"	049 TG 13	14	37	16

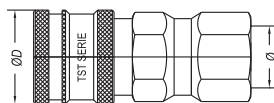

Female Thread Coupling
Kupplung mit Innengewinde

NPT 1/8"	049 NG 10	14	37	16
----------	-----------	----	----	----

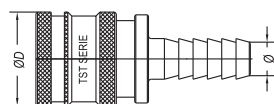

Standard Hose Barb Coupling
Kupplung mit Schlauchtülle

Ø4	049 HG 04		39	16
Ø6	049 HG 06		39	16

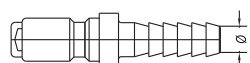

Standard Hose Barb Plug
Nippel mit Schlauchtülle

Ø3 1/8"	049 HU 03		32	10
Ø4 5/32"	049 HU 04		32	10
Ø5 3/16"	049 HU 05		38	10
Ø6 1/4"	049 HU 06		38	10

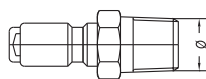

Male Thread Plug
Nippel mit Aussengewinde

Ø4	049 TU 10	11	31	
Ø6	049 TU 13	14	36	

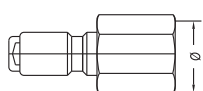

Female Thread Plug
Nippel mit Innengewinde

NPT 1/8"	049 NU 10	14	30.2	
----------	-----------	----	------	--